

## Repair Instructions

## Front Wheel Components

BENE31J12406001

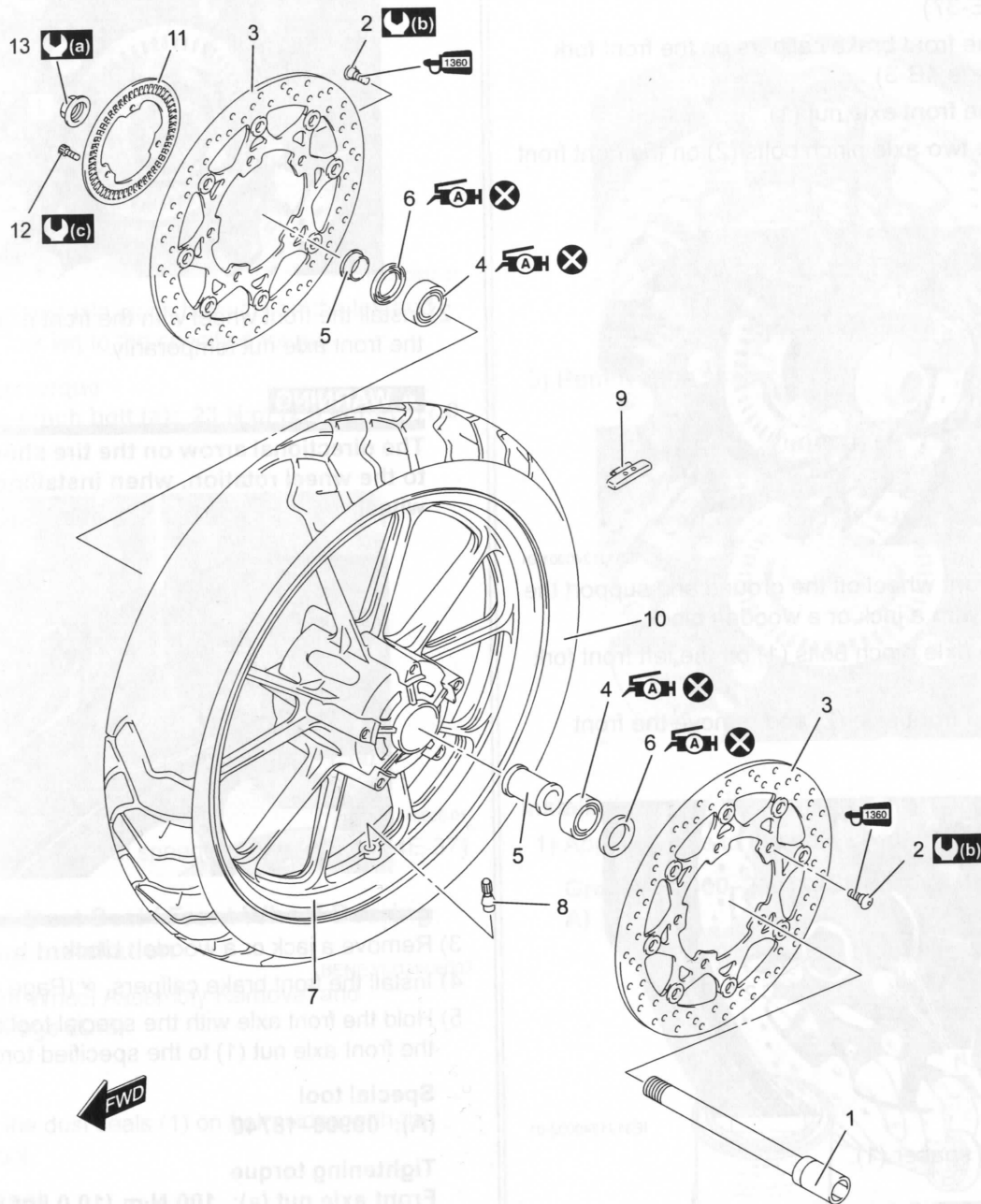

IE31J1240042-01

|                    |                   |  |  |
|--------------------|-------------------|--|--|
| 1. Front axle      | 6. Dust seal      | 11. Front wheel speed sensor rotor       | U(c) : 6.5 N-m (0.65 kgf-m, 5.0 lbf-ft)  |
| 2. Brake disc bolt | 7. Front wheel    | 12. Wheel speed sensor rotor bolt        | HA : Apply grease.                       |
| 3. Brake disc      | 8. Air valve      | 13. Front axle nut                       | 1350 : Apply thread lock to thread part. |
| 4. Bearing         | 9. Wheel balancer | U(a) : 100 N-m (10.0 kgf-m, 72.5 lbf-ft) | X : Do not reuse.                        |
| 5. Collar          | 10. Front tire    | U(b) : 23 N-m (2.3 kgf-m, 17.0 lbf-ft)   |  |

## Rear Wheel Components

BENE31J12406004

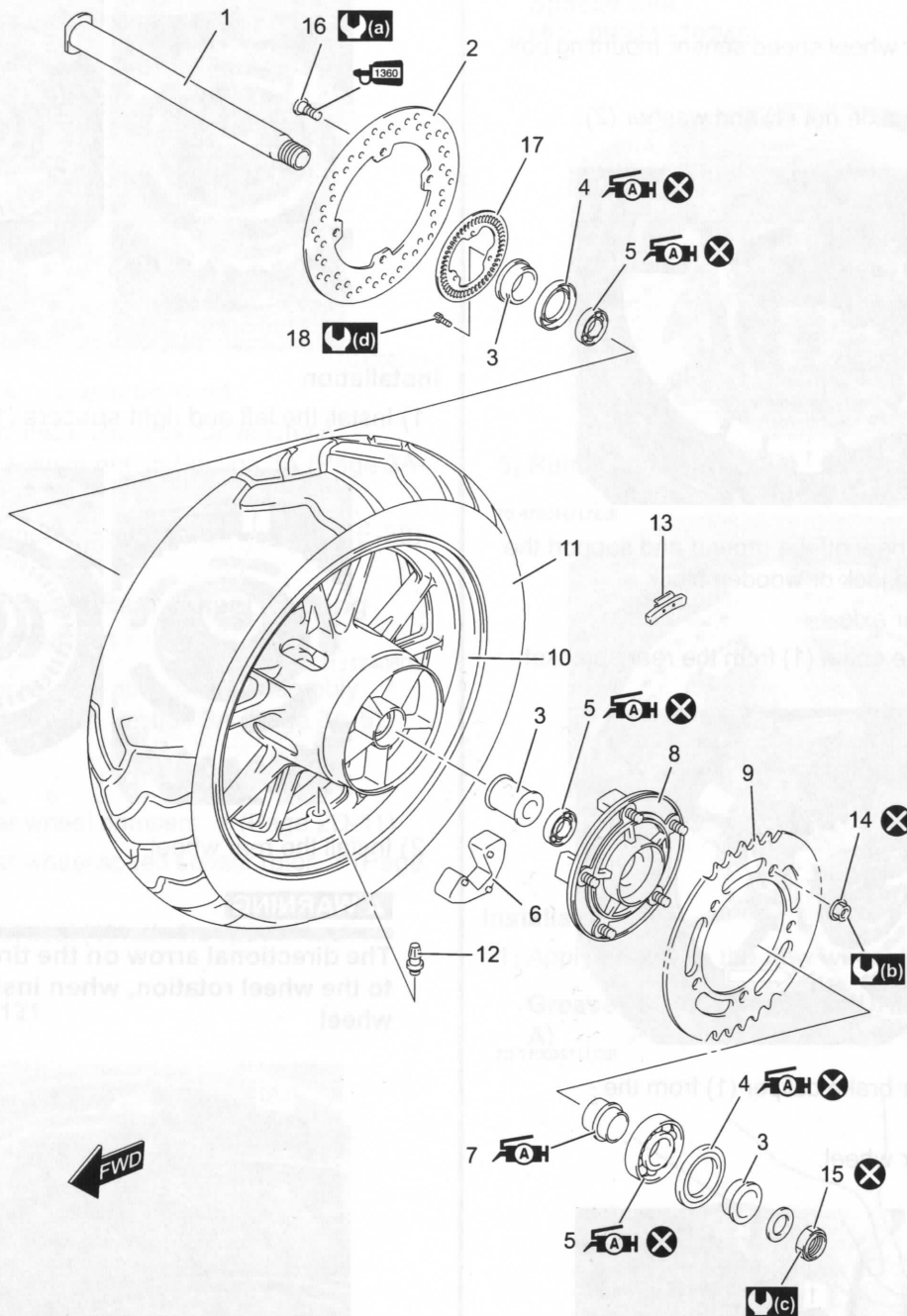

IE31J1240043-01

|                                |                                   |  |
|--------------------------------|-----------------------------------|--|
| 1. Rear axle                   | 10. Rear wheel                    | U(a) : 23 N·m (2.3 kgf-m, 17.0 lbf-ft)   |
| 2. Brake disc                  | 11. Rear tire                     | U(b) : 60 N·m (6.0 kgf-m, 43.5 lbf-ft)   |
| 3. Spacer                      | 12. Air valve                     | U(c) : 100 N·m (10.0 kgf-m, 72.5 lbf-ft) |
| 4. Dust seal                   | 13. Wheel balancer                | U(d) : 6.5 N·m (0.65 kgf-m, 5.0 lbf-ft)  |
| 5. Bearing                     | 14. Rear sprocket nut             | HA : Apply grease.                       |
| 6. Rear wheel damper           | 15. Rear axle nut                 | 1360 : Apply thread lock to thread part. |
| 7. Retainer                    | 16. Brake disc bolt               | X : Do not reuse.                        |
| 8. Rear sprocket mounting drum | 17. Wheel speed sensor rotor      |  |
| 9. Rear sprocket               | 18. Wheel speed sensor rotor bolt |  |